

Marine Safety Information Bulletin

Commander
U.S. Coast Guard
Sector Delaware Bay
1 Washington Ave
Philadelphia, PA 19147

MSIB Number: 15-20
Date: June 26, 2020
Contact: Waterways Management Staff
Phone: (215) 271-4814
E-Mail: DelawareBayWWM@uscg.mil

SUBMERGED OBJECT DELAWARE RIVER – MARCUS HOOK ANCHORAGE Update 1

The Captain of the Port, Delaware Bay, is notifying mariners of a submerged object that has been reported in Marcus Hook Anchorage on the Delaware River. Mariners are advised to use extreme caution when transiting this portion of the Delaware River as depth at mean low low water could be hazardous to navigation. Vessels drafting over 30 feet should avoid this area and transit around the object. **Object has moved approximately 550 feet upriver and may continue to do so. The previous location on June 24, 2020, and the new location as of June 26, 2020, are listed below.**

- Marcus Hook Anchorage Object:
 - June 24:
 - Minimum depth 33.4 feet at mean low low water.
 - Approximate location 39° 48.000962' N, 075° 24.87166' W
 - June 26:
 - **Minimum depth 34 feet at mean low low water.**
 - **Approximate location 39° 48.062619' N, 075° 24.778485' W**

The U.S. Army Corps of Engineers is currently evaluating the object and assessing the potential for removal.

Please see the attached chartlet for further information. The attached chartlet is for informational purposes only. **The object may continue to move within the Delaware River.** Vessels transiting the area should exercise extreme caution.

If you have any questions regarding the content of this bulletin, please contact the Waterways Management staff at (215) 271-4814 or the Command Center at (215) 271-4807.

J. D. THEEL
Captain, U.S. Coast Guard
Captain of the Port, Delaware Bay

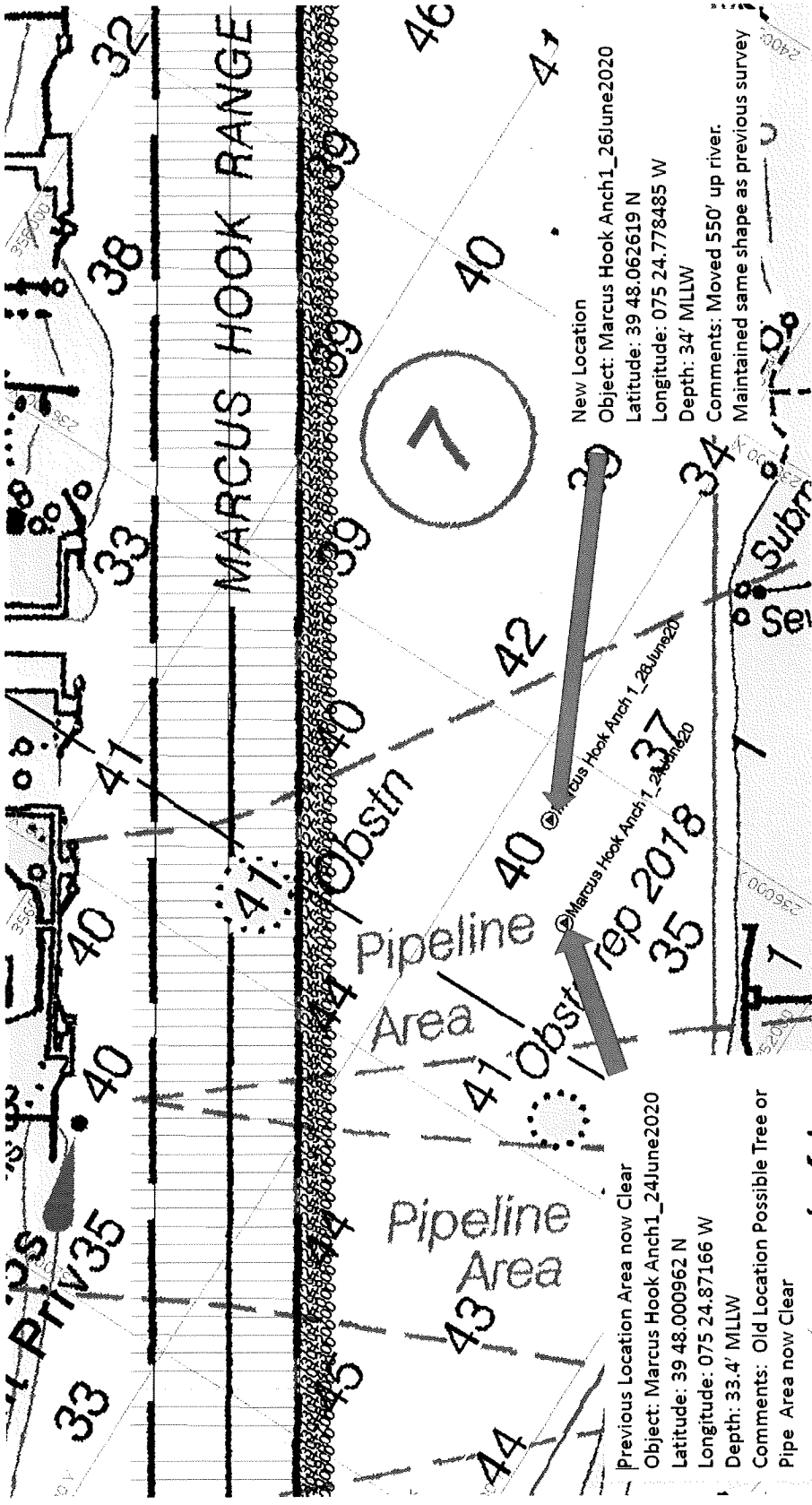

New Location
 Object: Marcus Hook Anch1_26June2020
 Latitude: 39 48.062619 N
 Longitude: 075 24.778485 W
 Depth: 34' MLLW
 Comments: Moved 550' up river.
 Maintained same shape as previous survey

Previous Location Area now Clear
 Object: Marcus Hook Anch1_24June2020
 Latitude: 39 48.000962 N
 Longitude: 075 24.87166 W
 Depth: 33.4' MLLW
 Comments: Old Location Possible Tree or
 Pipe Area now Clear

This release has been issued for public information and notification purposes only.